

INSTALLATION

INSTALLING INTERNAL CORNERS

What you will need:

- Contact Adhesive
- Seam Roller
- Penny Roller

Guide:

The excess material in the corner can be formed into a 'pigs ear' or double layer triangle of membrane. This can be attached to either wall. Contact Adhesive is used for all the bonds in an internal corner. It must be applied then allowed to flash off until touch dry before mating.

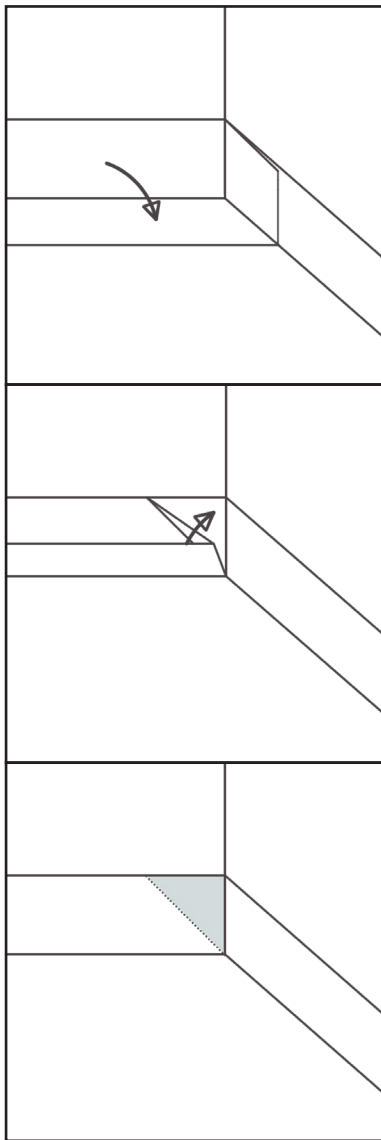

1. Attach the membrane to one upstand leaving the corner loose.
2. Fold the loose EPDM back onto the deck.
3. For the neatest look, attach the membrane to the upstand around the corner and out at a 45-degree angle from the corner.
4. Using Contact Adhesive on both surfaces of the rear of the EPDM, create the pigs ear (flap of excess material).
5. Again, using Contact Adhesive, fit the pigs ear back against the membrane and upstand.
6. Use Seam and Penny Rollers to ensure a good bond and tight angel changes.