

INSTALLATION

FIXING EPDM WITH A TERMINATION BAR

What you will need:

- Termination Bar
- Water Block
- Lap Sealant
- Drill

Guide:

Termination Bars can be used to fix the edge of the membrane on an upstand or to join EPDM to other roofing materials on the deck (please note EPDM cannot be joined to asphalt or bitumen).

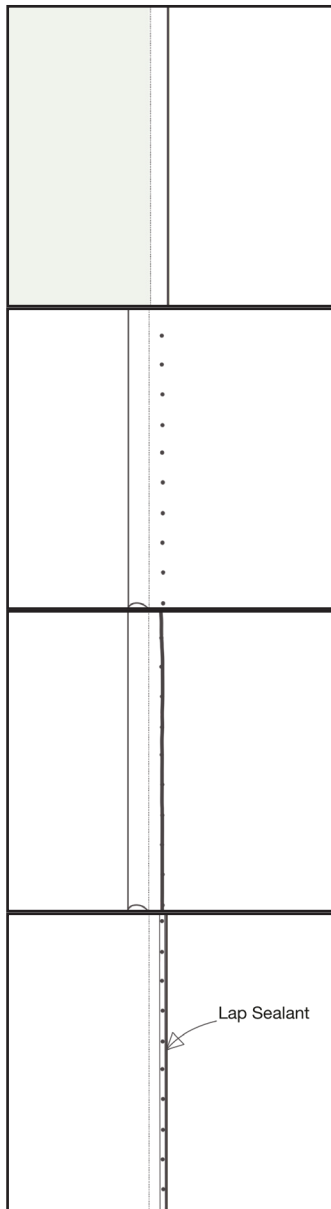

1. Adhere the membrane to the deck/wall as usual.
2. Ensure a 25mm minimum overlap if adjoining to another roofing material, and a 50mm unglued seam.
3. Fold back the membrane and use the Termination Bar to mark the position for drilling.
4. Drill fixing holes in the marked position.
5. Apply a continuous bead of Water Block to the wall/deck, behind the EPDM, where the Termination Bar will be fitted.
6. Roll the membrane up over the Water Block.
7. Fix the Termination Bar through the EPDM, over the Water Block, then trim the membrane back to the outer edge of the Termination Bar.
8. Apply a bead of Lap Sealant to the outer edge of the Termination Bar to ensure no water gets behind the membrane.